

# SURFACE MOUNT LED EXIT SIGN

EMERGENCY BATTERY BACKUP

TEXZEM / EUGEM Series

## INSTALLATION & OPERATION INSTRUCTIONS

### Package Contents

Part	Description	Quantity
1	LED Edge-Lit EXIT Sign	1
2	Canopy	1
3	Hardware Bag	1

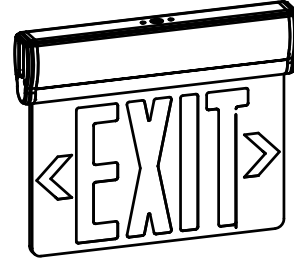

### Warnings and Cautions

## IMPORTANT SAFEGUARDS

### READ AND FOLLOW ALL SAFETY INSTRUCTIONS.

When using electrical equipment, basic safety precautions should always be followed including the following

1. Before starting the installation, disconnect the power by turning off the circuit breaker or by removing the appropriate fuse at the fuse box. Using the light switch to turning the power off is not sufficient to prevent electrical shock.
2. Do not use outdoors.
3. Do not mount near gas or electric heaters.
4. Use caution when servicing batteries. Battery acid can cause burns to skin and eyes. If acid is spilled on skin or eyes, flush acid with fresh water and contact a physician immediately.
5. Equipment should be mounted in locations and at heights where it will not be subjected to tampering by unauthorized personnel.
6. The use of accessory equipment not recommended by the manufacturer may cause an unsafe condition.
7. Do not use this equipment for other than its intended use.
8. All servicing should be performed by qualified personnel only.
9. Allow battery to charge for 24 hours before first use.

## SAVE THESE INSTRUCTIONS

### ELECTRICAL CONNECTIONS

- Make the proper supply wire connections.
- If using 120VAC, connect the black and white wires to the building utility.
- If using 277VAC, connect the orange and white wires to the building utility.
- Cap off unused wires. In all cases, use standard wire nuts to connection to wires.

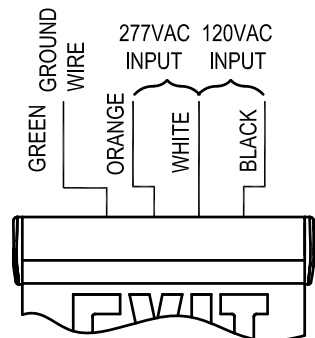

### Conversion from double face mirror to single face mirror:

To convert Double Face Mirror to Single Face Mirror, remove protective liner from adhesive strips supplied on the Mirror film. Center the mirrored film over the desired unused face and press firmly to adhere. Remove protective "blue" film from the mirror and faces.

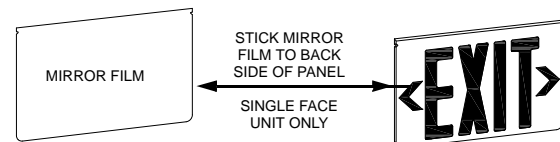

### Determine chevron placement:

- a. If a chevron is needed, leave the chevron on and remove only the film instruction.
- b. If no chevron is needed, remove the chevron and film instructions together.



# Mounting Instructions

**NOTE: First turn off electricity.**

## Surface Ceiling & Wall Mounting

1. Attach crossbar to junction box. (TM8#-32\*-1)
2. Use screwdriver to open the front cover, then connect the battery.

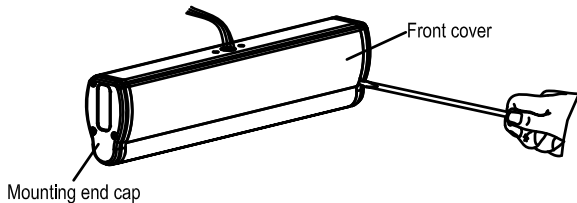

3. Feed AC supply wires through canopy center hole.
4. Assemble canopy onto main body assembly with (2) PM4\*12 screws (supplied) and make proper wire connections. (See ELECTRICAL CONNECTIONS).
5. Using (2) PM4-40 screws (supplied) tighten canopy to crossbar.

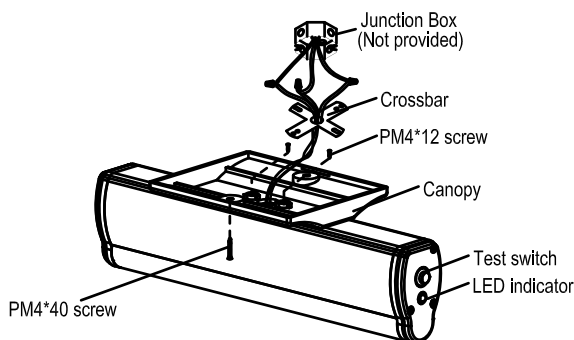

6. Peel off protection film from both sides of the EXIT panel, gently insert EXIT panel into main body assembly. If the EXIT panel is single, ensure that the EXIT letter direction is correct.

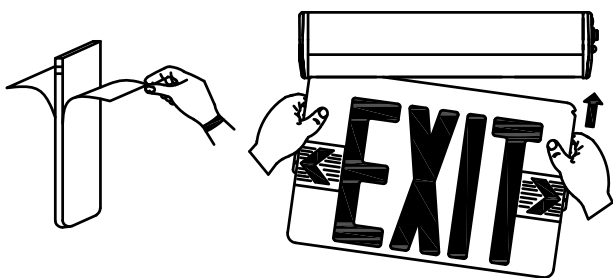

7. Determine direction for chevron placement. (See DETERMINE DIRECTION)

8. The unit can be installed on any flat surface. The EXIT panel can pivot in any angle from 0° to 180°, for wall mounting rotate the panel 90° from the ceiling mounting.

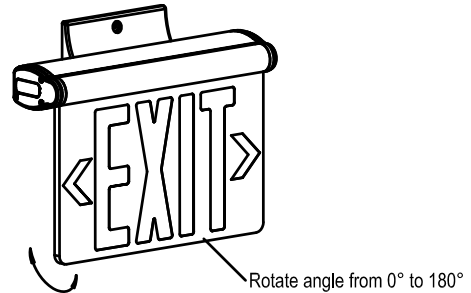

## Surface Side Mounting

1. Attach crossbar to junction box.
2. Use a screwdriver to open the front cover to connect the battery connector.
3. Remove the hole plug from mounting end cap.
4. Pull out all AC supply wires and feed wire through the center hole of the mounting cap and then the canopy.
5. Reference steps 4-8 in surface ceiling & wall mounting above to finalize installation.

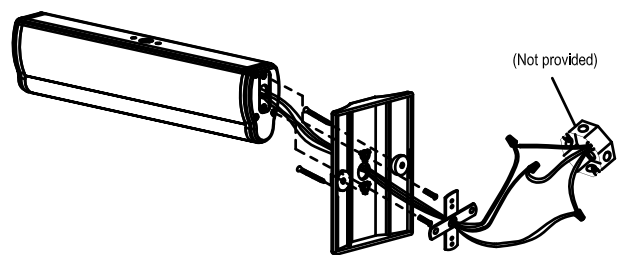

## MAINTENANCE

Battery will require a charge period if product was kept in storage for over 9 months, detail manual refer "BATTERY STOCK AND RECHARGE GUIDELINE". We recommend that the equipment be tested regularly in accordance with local codes. Replace the batteries as needed if discharge time does not achieve the required 90 minutes.

## OPERATION

Press the test button, unit will be illuminated by battery backup and the LED indicator will be turned off. Release the test switch, LED indicator will be turned on.

## TROUBLE SHOOTING GUIDE

If LED array or LED indicator does not illuminate, check the following:

1. Check AC supply - Verify that the unit has constant 24 hour AC supply.
2. Battery connection, verify the battery is connected properly.
3. Discharge battery and charge battery for 24 hours and then retest.
4. If the above troubleshooting does not solve the problem, please contact the factory for assistance.