

INSTALLATION AND OPERATING INSTRUCTIONS

IMPORTANT SAFEGUARDS!!! SAVE THESE INSTRUCTIONS!!!

READ AND FOLLOW ALL SAFETY INSTRUCTIONS

When using electrical equipment, basic safety precautions should always be followed, including the following:

1. Review the diagrams and instructions thoroughly before beginning installation.
2. All electrical connections must comply with local codes, ordinances, and the National Electrical Code.
3. Disconnect power at the fuse or circuit breaker before installing or servicing the unit.
4. Do not mount in hazardous locations or near gas or electric heaters.
5. Do not allow power cords to be in contact hot surfaces.
6. Equipment should be mounted in locations and at heights where it will not be subjected to tampering by unauthorized personnel.
7. The use of accessory equipment not recommended by the manufacturer may cause unsafe or failed fixture operation and may void warranty.
8. Do not use this equipment for purposes other than its intended use.
9. All servicing should be performed by qualified personnel only.

NOTICE: WEAR GLOVES WHEN INSTALLING OR HANDLING

FUNCTION

1. This light fixture is designed for operation with an AC power supply of 120-277V, 60Hz. It can be field configured for one of the following operating modes:

Dusk-to-Dawn Operation (default setting) – Automatically controlled by the integral photo sensor.

Wall Switch (Remote) Operation – Controlled manually via an external switch or contact.

Normally-Off Emergency Operation – Remains off under normal conditions and is energized only when powered by an emergency AC supply.

2. In photo sensor mode, if the ambient illuminance is <1FC (10 Lux), the fixture will turn on automatically. When the ambient illuminance >3FC (30 Lux), the fixture will turn off. (See Fig. 7)

3. For Normally-off or Switched function See Fig. 8

PHOTO SENSOR ☐ WALL SWITCH

Slide switch to select function

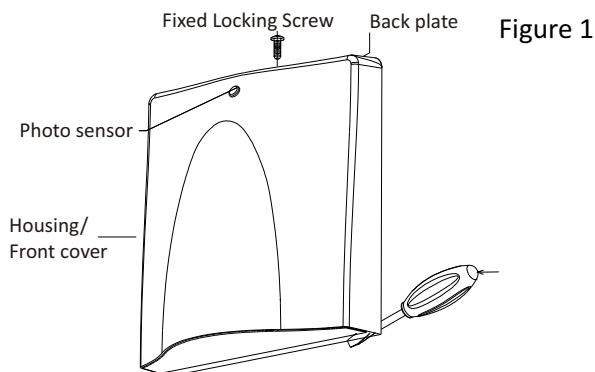
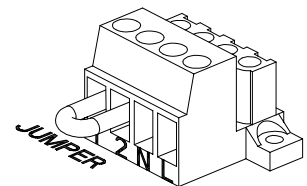

Figure 1

NOTICE:

The front cover and back plate are packaged separately. If you need to separate them after installation, remove the fixed locking screw and then insert a screwdriver into a corner gap between the front cover and base and carefully pry open the front cover.

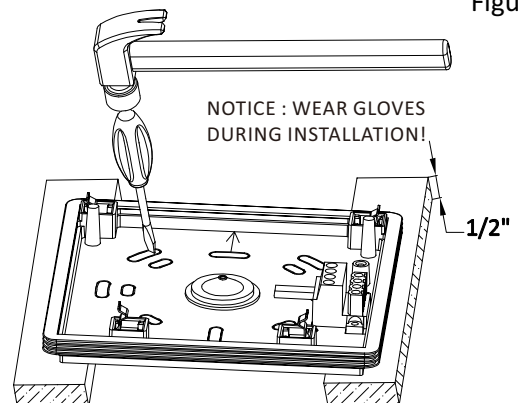

Figure 2

NOTICE:

Keep the back plate at least 1/2 inch away from the support surface when drilling or knocking out mounting holes.

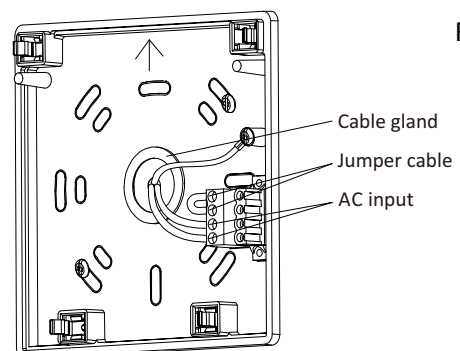
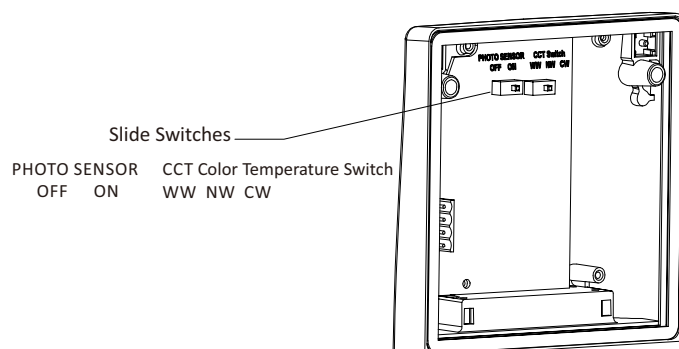
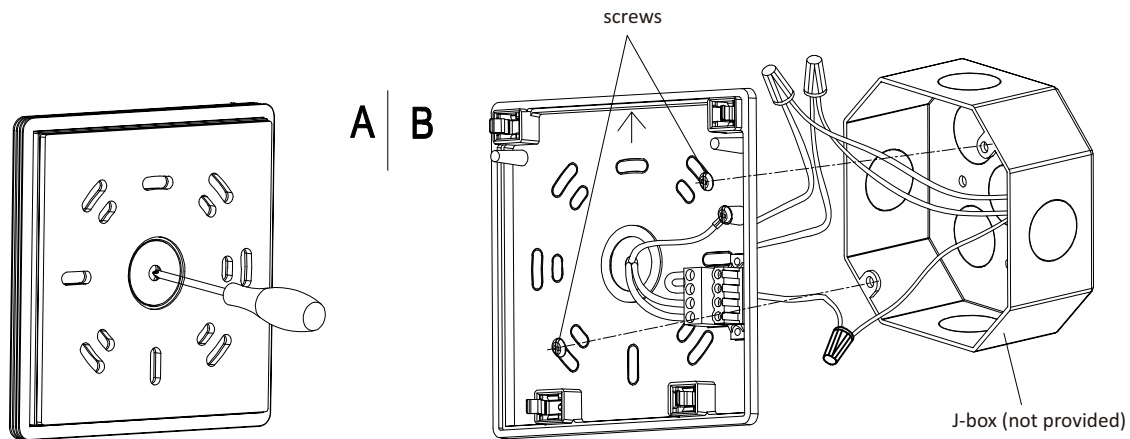

Figure 3

Figure 4

**NOTICE:**

Ensure screws are secure and not over tightened to prevent the back plate from deforming, which could affect the waterproof function.

Figure 5

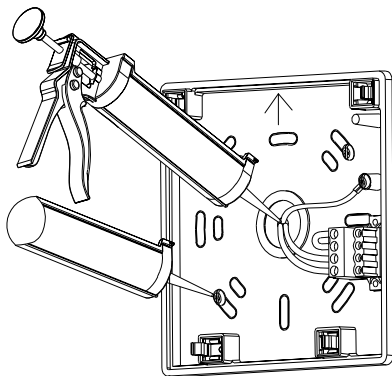
**NOTICE:**

After installation, apply silicone sealant to all exposed areas to ensure waterproofing.

Figure 6

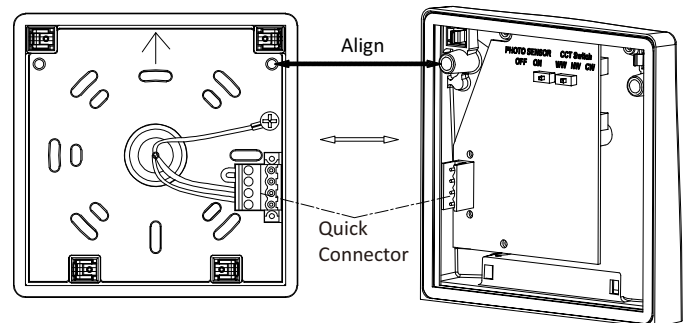
**NOTICE:**

Assemble the front cover onto the back plate securely.

Wiring Diagram for Dusk-to-Dawn Photo Sensor Operation Figure 7



Follow the wiring diagram in Fig. 7. slide the photo sensor switch to ON (factory default). The fixture will automatically turn on/off based on ambient light levels.

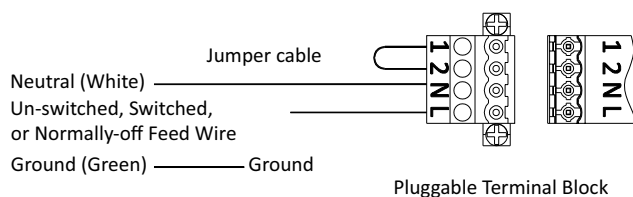

Pluggable Terminal Block

Wiring Diagram for Remote Switch Operation

Figure 8

Toggle the slide switch down to bypass the photo sensor. Remove the jumper cable and connect the wall switch between terminals 1 & 2. (See Fig. 8). Terminal 1 is the hot switched output from switch. Terminal 2 is hot Un-Switched feed to the switch (same feed as L). Alternatively, a Switched or Normally-off operation can also be achieved by connecting the Hot Switched or Normally-off source to the "L" hot wire terminal. In this scenario please leave the jumper between Terminal 1 & 2 installed.

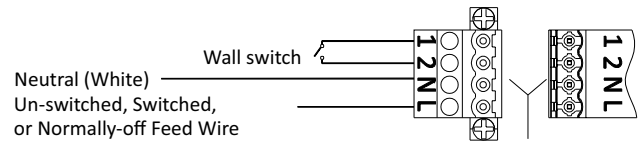

Pluggable Terminal Block

Wall Mount Installation for Back Power Feed

1. The front cover and back plate are packaged separately. To separate them after installation, remove the fixed locking screw and inserting a screwdriver into the corner gap and carefully pry open the front cover. (See Fig. 1)
2. Remove the appropriate knockout mounting holes on the back plate. (See Fig. 2)
3. Use a Phillips screwdriver to pierce the center cable gland entry on the back plate. (See Fig. 4A)
4. Feed the unit wires out through the center cable entry gland and into the J- box, connect supply wires in J-box using the provided wire nuts:
 White wire → Neutral
 Black wire → Hot lead (120-277V)
 Green wire → Ground
5. Secure the back plate to the J-box and apply silicone sealant to all open areas. (See Fig. 4)
6. Attach the front cover to the back plate. (See Fig. 5)
7. Secure the fixed locking screw at the top to finalize the installation. (See Fig. 1)