

# TELESIS TDCOM

## Die-Cast LED Combo Exit Sign

The Telesis TDCOM Die Cast Aluminum Combination LED Exit and Emergency Light provides an architectural styled solution for applications needing a rugged yet stylish combination unit. Available in brushed aluminum, all black, or all white finishes, it combines durability with a sleek, modern design.



### CONSTRUCTION

- Durable die cast aluminum with powder coat finish
- Letters are 6 inch high with 3/4 stroke available in red or green
- Aluminum mounting canopy is included for top or end mount applications
- Universal knockout pattern on back plate for wall mounting (single face models)
- Chevron directional indicators are field selectable
- Face plate snaps closed with no visible hardware

### ELECTRICAL

- Long life Nickel Cadmium battery provides 90 minutes of emergency operation with optional 3-watts remote capacity
- 120/277 VAC field selectable input
- Push to test switch and LED status indicator

- Fully automatic operation solid state transfer to emergency mode
- Fully automatic solid state two rate charger recharges battery in 24 hours

### ILLUMINATION

- Long Life Energy efficient LED letter illumination
- Bottom mounted bright white led heads 3 watts each

### CERTIFICATION

- UL 924 Listed and Listed for damp locations, 0 to 50°C, meets NFPA 101, NFPA 70-NEC, OSHA, Local and State codes
- California Energy Commission (CEC) Title 20 Compliant and OSHA requirements

### WARRANTY

- 5 year limited warranty, battery pro-rated - view complete warranty terms online at [www.evenlite.com/terms-warranty](http://www.evenlite.com/terms-warranty).

### ORDERING GUIDE

TDCOM-R-1-AB-RC

| MODEL | LETTER COLOR | FACE COUNT                 | FACE & HOUSING COLOR                    | OPTIONS  | ORDERING NOTES   |
|-------|--------------|----------------------------|---|--|--|
| TDCOM | R Red        | 1 Single                   | AB Brushed Aluminum Face, Black Housing | <b>FIXTURE OPTIONS</b>                           | 1 Remote Capacity is 3 watts<br>2 Dimensions: 13.5" H x 15" W x 6" D<br>3 Ordered Separately |
|       | G Green      | 2 Double                   | AA Brushed Aluminum Face and Housing    | RC Remote Capacity <sup>1</sup>                  |  |
|       |              | U Universal with Backplate | BB Black Face and Housing               | M990005 Wire Guard <sup>2</sup>                  |  |
|       |              |                            | WW White Face and Housing               | <b>COMPATIBLE REMOTE HEADS<sup>3</sup></b>       |  |
|       |              |                            |   | PILED-MV Single Indoor Multi-Volt Remote Head    |  |
|       |              |                            |   | PILED2-MV Double Indoor Multi-Volt Remote Head   |  |
|       |              |                            |   | PRWLED1-MV Single Outdoor Multi-Volt Remote Head |  |
|       |              |                            |   | PRWLED2-MV Double Outdoor Multi-Volt Remote Head |  |
|       |              |                            |   | HL High Lumen Remote Option                      |  |
| TDCOM |              |                            |   |  |  |

Fill in fields from categories above and complete type and part number.

Type No:

Full Part No:

DIMENSIONS

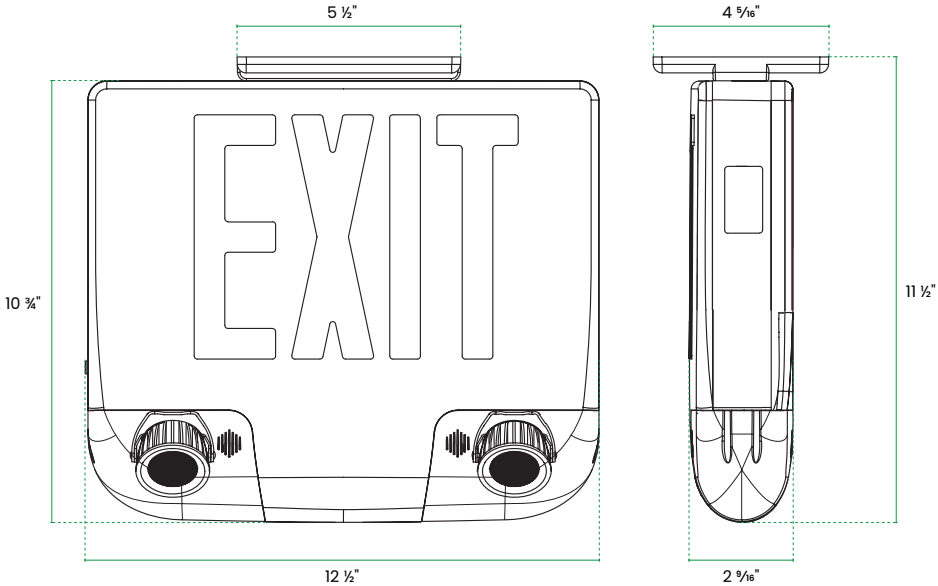

REMOTE LAMP COMPATIBILITY

| COMPATIBLE REMOTE HEADS                    | TOTAL WATTAGE |
|--|---------------|
| PILED1-MV (Single Indoor)                  | 1.0           |
| PILED2-MV (Double Indoor)                  | 2.0           |
| PILED1-MV-HL (Single Indoor, High Lumen)   | 1.5           |
| PRLED2-MV-HL (Double Indoor, High Lumen)   | 3.0           |
| PRWLED1-MV (Single Outdoor)                | 1.0           |
| PRWLED2-MV (Double Outdoor)                | 2.0           |
| PRWLED1-MV-HL (Single Outdoor, High Lumen) | 1.5           |
| PRWLED2-MV-HL (Double Outdoor, High Lumen) | 3.0           |

Maximum Wattage for TDCOM with RC option: 3

ELECTRICAL INFORMATION

| INPUT WATTS (W) |      | INPUT AMPS (A) |       |
|-----------------|------|----------------|-------|
| 120V            | 277V | 120V           | 277V  |
| 4.6             | 4.8  | 0.053          | 0.024 |

CENTER-TO-CENTER SPACING GUIDELINES

For reference only.

For reference only.

UNIT

LOCATION

LIGHT SOURCE

|   |      |      |      |      |      |      |      |      |      |      |      |      |      |      |      |      |      |      |      |      |      |      |      |      |    |
|---|------|------|------|------|------|------|------|------|------|------|------|------|------|------|------|------|------|------|------|------|------|------|------|------|----|
| 1 | 0.07 | 0.10 | 0.15 | 0.25 | 0.53 | 0.96 | 1.13 | 2.13 | 1.75 | 1.22 | 0.82 | 0.53 | 0.54 | 0.72 | 0.83 | 0.78 | 0.66 | 0.54 | 0.44 | 0.27 | 0.20 | 0.10 | 0.06 | 0.03 |    |
| 2 | 0.08 | 0.11 | 0.16 | 0.28 | 0.49 | 1.03 | 1.92 | 3.03 | 2.70 | 1.89 | 1.20 | 1.00 | 1.05 | 1.30 | 1.59 | 1.60 | 1.57 | 1.29 | 0.91 | 0.53 | 0.27 | 0.14 | 0.07 | 0.04 |    |
| 3 | 0.07 | 0.10 | 0.16 | 0.26 | 0.45 | 0.84 | 1.77 | 3.27 | 4.03 | 2.85 | 1.64 | 1.43 | 1.77 | 2.50 | 3.24 | 3.10 | 2.50 | 1.70 | 0.96 | 0.52 | 0.26 | 0.13 | 0.07 | 0.04 |    |
| 4 | 0.07 | 0.10 | 0.16 | 0.24 | 0.40 | 0.70 | 1.45 | 2.58 | 3.60 | 3.00 | 1.98 | 1.86 | 2.58 | 3.90 | 4.62 | 3.72 | 2.34 | 1.29 | 0.67 | 0.39 | 0.20 | 0.12 | 0.06 | 0.04 |    |
| 5 | 0.06 | 0.10 | 0.14 | 0.21 | 0.34 | 0.53 | 0.95 | 1.68 | 2.31 | 2.53 | 2.22 | 2.14 | 2.58 | 3.08 | 3.22 | 2.22 | 1.43 | 0.95 | 0.49 | 0.25 | 0.14 | 0.09 | 0.06 | 0.03 |    |
| 6 | 0.05 | 0.07 | 0.11 | 0.17 | 0.24 | 0.36 | 0.60 | 0.96 | 1.41 | 1.89 | 1.96 | 1.81 | 1.68 | 1.56 | 1.35 | 1.11 | 0.76 | 0.47 | 0.29 | 0.18 | 0.12 | 0.08 | 0.05 | 0.03 |    |
|   | 12   | 11   | 10   | 9    | 8    | 7    | 6    | 5    | 4    | 3    | 2    | 1    | 0    | 1    | 2    | 3    | 4    | 5    | 6    | 7    | 8    | 9    | 10   | 11   | 12 |

Meets NFPA 101 Requirements for: 24'+ center-to-cent spacing - 6'+ path of egress from wall - 9' mounting height.