

# INSTALLATION AND OPERATING INSTRUCTIONS

## IMPORTANT SAFEGUARDS!!! SAVE THESE INSTRUCTIONS!!!

### READ AND FOLLOW ALL SAFETY INSTRUCTIONS

When using electrical equipment, basic safety precautions should always be followed, including the following:

1. Review the diagrams and instructions thoroughly before beginning installation.
2. All electrical connections must comply with local codes, ordinances, and the National Electrical Code.
3. Disconnect power at the fuse or circuit breaker before installing or servicing the unit.
4. Do not mount in hazardous locations or near gas or electric heaters.
5. Do not allow power cords to be in contact hot surfaces.
6. Equipment should be mounted in locations and at heights where it will not be subjected to tampering by unauthorized personnel.
7. The use of accessory equipment not recommended by the manufacturer may cause unsafe or failed fixture operation and may void warranty.
8. Do not use this equipment for purposes other than its intended use.
9. All servicing should be performed by qualified personnel only.
10. For EM models: Allow the battery to charge for 24 hours before first use.

### NOTICE: WEAR GLOVES WHEN INSTALLING OR HANDLING

#### FUNCTION

1. This light fixture is designed for operation with an AC power supply of 120-277V, 60Hz. It can be field configured for one of the following operating modes:  
Dusk-to-Dawn Operation (default setting) – Automatically controlled by the integral photo sensor.  
Wall Switch (Remote) Operation – Controlled manually via an external switch or contact.  
Normally-Off Emergency Operation – Remains off under normal conditions and is energized from the internal battery when AC supply fails.
2. In photo sensor mode, if the ambient illuminance is <1FC (10 Lux), the fixture will turn on automatically. When the ambient illuminance >3FC (30 Lux), the fixture will turn off. (See Fig. 7)
3. For Normally-off or Switched function See Fig. 8

PHOTO  
SENSOR  WALL  
SWITCH

Slide switch to select function

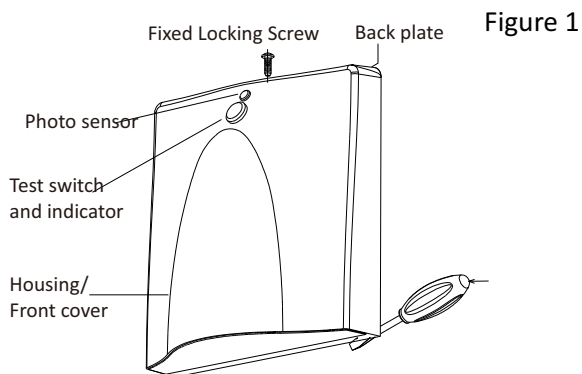
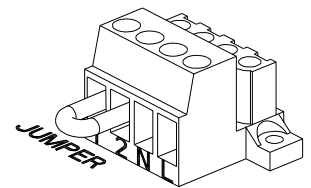

#### NOTICE:

The front cover and back plate are packaged separately. If you need to separate them after installation, remove the fixed locking screw and then insert a screwdriver into a corner gap between the unit and wall plate and carefully pry open the front cover.

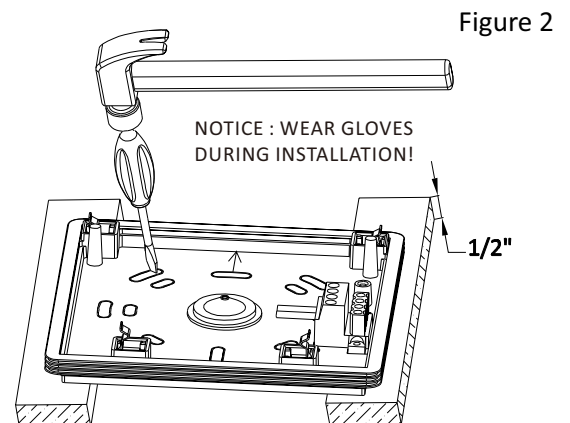

#### NOTICE:

Keep the back plate at least 1/2 inch away from the support surface when drilling or knocking out mounting holes.

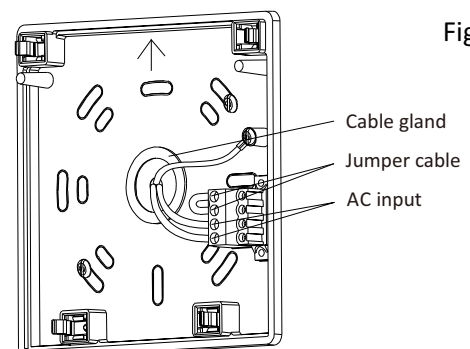
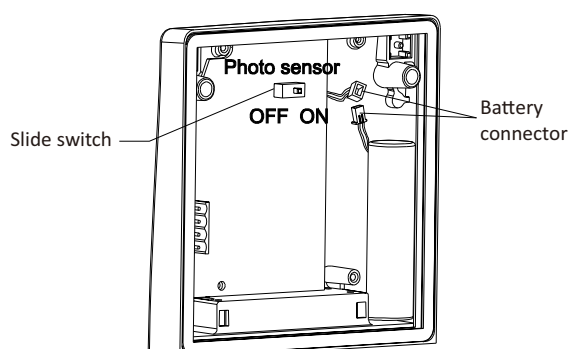
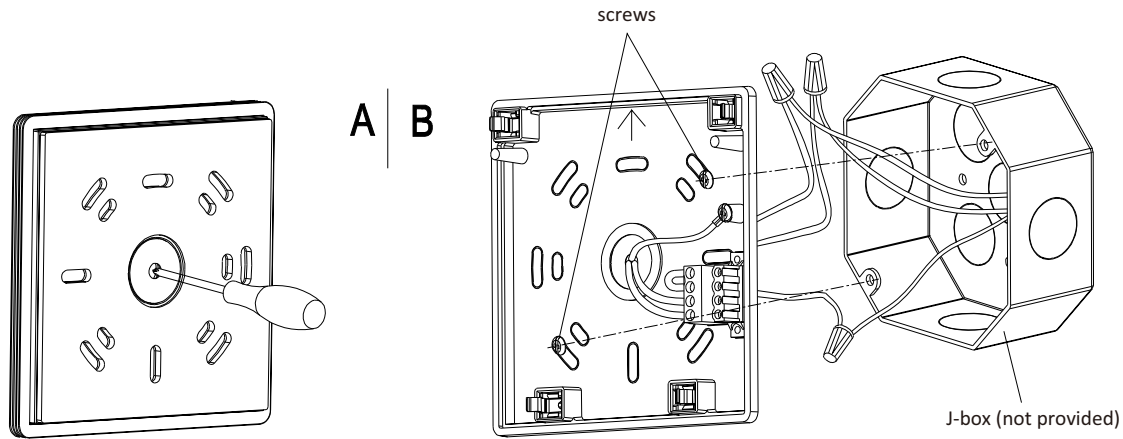
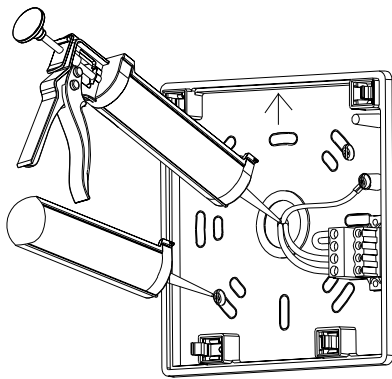

Figure 4

**NOTICE:**

Ensure screws are secure and not over tightened to prevent the back plate from deforming, which could affect the waterproof function.

Figure 5

**NOTICE:**

After installation, apply silicone sealant to all exposed areas to ensure waterproofing.

Figure 6

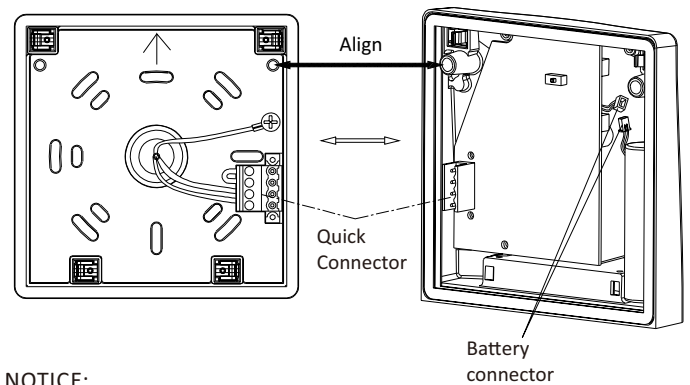
**NOTICE:**

Ensure that the battery connector is properly reconnected before assembling the front cover.

Wiring Diagram for Dusk-to-Dawn Photo Sensor Operation Figure 7



Follow the wiring diagram in Fig. 7. slide the photo sensor switch to ON (factory default). The fixture will automatically turn on/off based on ambient light levels.

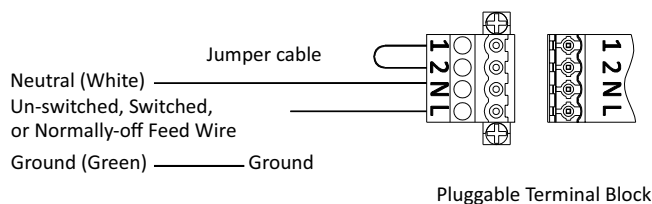

Wiring Diagram for Remote Switch Operation Figure 8

Figure 8

Toggle the slide switch down to bypass the photo sensor. Remove the jumper cable and connect the wall switch between terminals 1 & 2. (See Fig. 8). Terminal 1 is the hot switched output from switch. Terminal 2 is hot Un-Switched feed to the switch (same feed as L). Alternatively, a Normally-off operation can be achieved by removing the jumper between terminal 1 & 2. For Switched operation remove the jumper between terminal 1 & 2, connect the hot switched output to terminal 1.

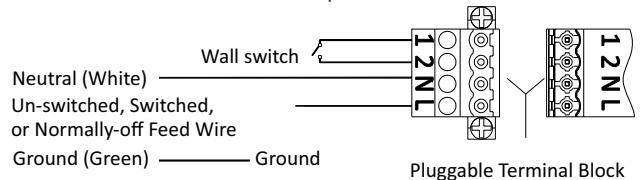

## Wall Mount Installation for Back Power Feed

1. Insert a flat-blade screwdriver into the corner gap between the front cover and the base. Rotate the screwdriver to remove the front cover from the back plate. (See Fig. 1)
2. Remove the appropriate knockout hole on the back plate. (See Fig. 2)
3. Use a Phillips screwdriver to pierce the center cable gland on the back plate. (See Fig. 4A)
4. Feed the unit wires through the center cable gland and connect them to the power supply wires using the provided wire nuts:  
 White wire → Neutral  
 Black wire → Hot lead (120-277V)  
 Green wire → Ground
5. Secure the back plate to the J-box and apply silicone sealant to all open areas. (See Fig. 4)
6. Reconnect the battery connector, then attach the front cover to the back plate. (See Fig. 5)
7. Secure the screw at the top to finalize the installation. (See Fig. 1)